

**Double Leaf EI<sub>2</sub>60 / T60 High Fire Retardant Acoustic Gate**

<b>Fire Protection</b>	<b>EI<sub>2</sub>60 / T60</b>	<b>tested acc. to EN 1634-1</b>
<b>Sound Insulation</b>	<b>R<sub>w,P</sub> 38 dB</b>	<b>tested acc. to EN ISO 10140-2</b>
<b>Smoke Control (optional)</b>	<b>S<sub>a</sub>, S<sub>200</sub> / RS</b>	<b>tested acc. to EN 1634-3</b>
<b>Self-Closing (optional)</b>	<b>up to C2</b>	<b>tested acc. to EN 1191</b>

**Certified in accordance with DIN EN 16034 / 14351-1 / 13241**

**Optional Audited Additional Functions**

- Burglar Protection	<b>RC2/RC3/RC4/RC5</b>	tested acc. to EN 1627
- Bullet Resistance	<b>FB4-NS</b>	tested acc. to EN 1522
- Air Tight	<b>up to class 3</b>	tested acc. to EN 12426
- Rain- and Fire-Water Tight	<b>class 1</b>	tested acc. to EN 12425
- Wind Load Resistance	<b>class 4</b>	tested acc. to EN 12424
- Blast Resistance	<b>up to 8 kPa</b>	tested acc. to EN 13124-1
- Explosion Protection	<b>up to zone 1/21</b>	acc. to EN 1127-1 or ATEX 2014/34/EU
- Stainless Steel		

**Range of Dimension**

**Width** from 3000 mm to 5000 mm  
**Height** from 3000 mm to 5000 mm

**Technical Specification and Tender Text**

<b>Product:</b>	<b>EI<sub>2</sub>60 / T60 double leaf high fire retardant acoustic door brand Buchele tested acc. to EN 1634-1 and EN ISO 10140-2</b>
<b>Door Type:</b>	<b>PLANE Line PL 602 XXL BASIC</b>
<b>Sound Insulation R<sub>w,P</sub></b>	<b>38 dB</b>
<b>Structural Opening:</b>	<b>.... x .... mm</b>
<b>Door Leaf:</b>	Double-walled, planar 84 mm thick steel door leaf without hinge embossing, three sides rebated with thick rebate Without bottom stop. Special insulating inserts fully laid-in and glued. Passive leaf with multi-chamber sealing profile in the middle rebate. Securing pin screwed in door leaf rebate. Drop sealing system.
<b>Threshold:</b>	Floor bracket as separation sill. Surface galvanized and welded to the frame.
<b>Frame:</b>	3-sided circumferential rebated corner frame with visible black coated intumescent material in rebate. High-quality multi chamber sealing profile adjustable fixed in the three-sided groove.
<b>Hinges:</b>	Three-part, height adjustable construction hinges with hinge pin retention and ball bearing spacer ring for smooth door movement.

<b>Door Closer:</b>	2 pieces door closer system with standard arm acc. to EN 1154 silver coloured mounted on hinge side. Door coordinator and 2 pieces of 30 mm high brackets with plastic roller.	
<b>Fitting:</b>	<b>Active leaf</b> with mortise lock with latch lever function acc. to EN 12209 (prepared for installation of a profile cylinder lock, provided by customer). Door handle set in acc. to EN 1906 fixed pivoted synthetic material black in U-shape with rounded short-plate. <b>Passive leaf</b> with self-locking concealed shoot bolt lock with upper switch lock.	
<b>Surface:</b>	Door leaf and frame galvanized und primed with 2K-PUR primer (Very High Solid) similar RAL 7035.	
<b>Installation:</b>	masonry	≥ 240 mm
	concrete	≥ 240 mm
	areated concrete	on request
	mounting wall F60	on request

### Alternative: PLANE Line PL 602 PREMIUM with flush mounted optics

<b>Frame:</b>	3-sided circumferential rebated PLANE Line special corner frame for flush mounted optics on hinge side. With visible, black coated intumescent material in rebate. High-quality multi-chamber sealing profile adjustable fixed in the three-sided groove.	
<b>Hinges:</b>	Three-part, height adjustable construction hinges with hinge pin retention and ball bearing spacer ring for smooth door movement.	
<b>Door Closer:</b>	<b>Up to gate width of 3300 mm</b> slide rail door closer system acc. to EN 1154 silver coloured mounted on hinge side.  <b>From gate width of 3300 mm</b> 2 pieces door closer system with standard arm acc. to EN 1154 silver coloured mounted on hinge side. Door coordinator and 2 pieces of 30 mm high brackets with plastic roller.	

### Supplementary Equipment

<b>Glazing:</b>	F60 fire-protective glazing fixed with profiled and visible screwed steel glazing bars. Range of dimension on request.	
<b>Stainless Steel:</b>	Material 1.4301 (V2A) or 1.4404 (V4A), Surface mill finish or brushed.	
<b>BUCHELE DELUXE:</b>	The exclusive surface coating.	

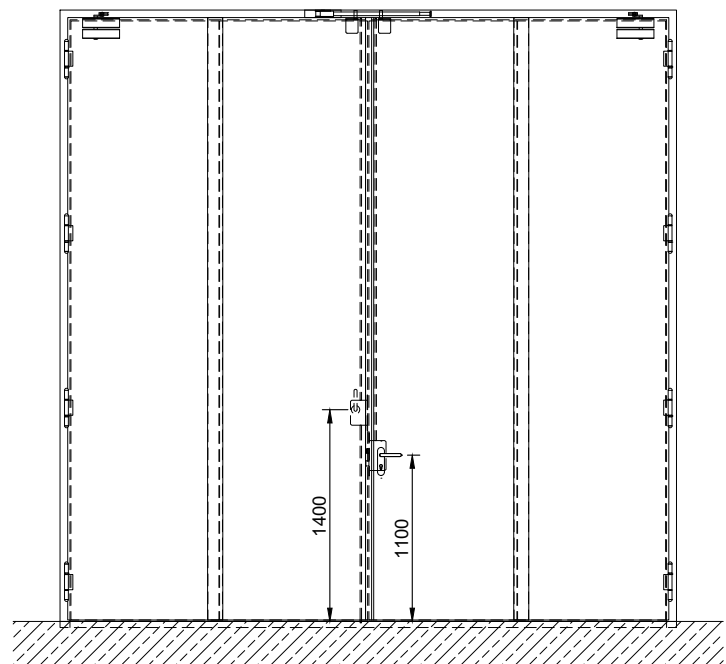
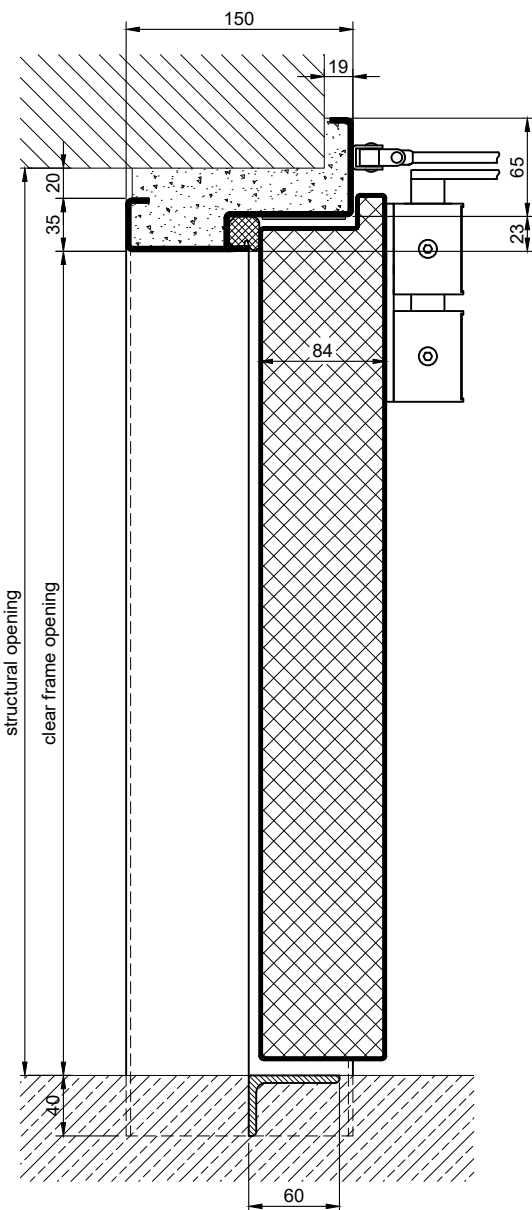
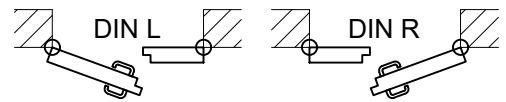
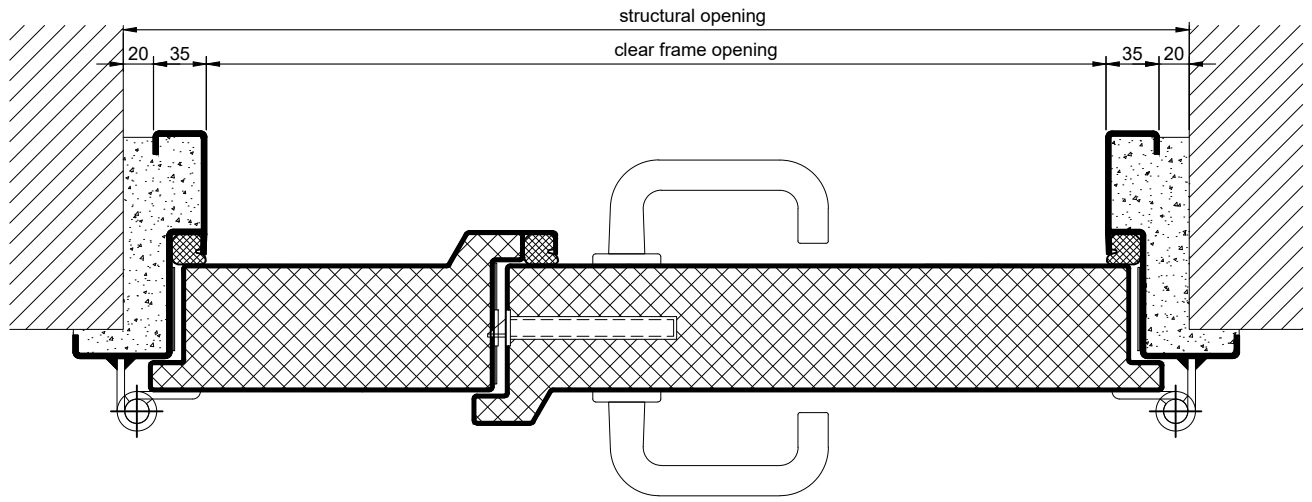

1.31.13\_PLANE LINE PL 602 XXL 38 DB\_EN

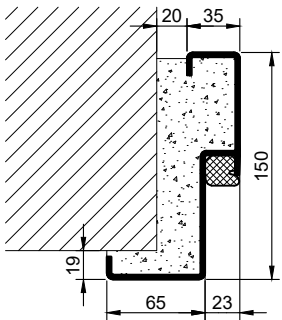
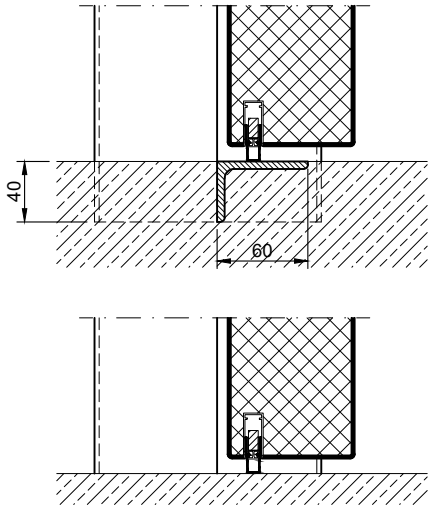
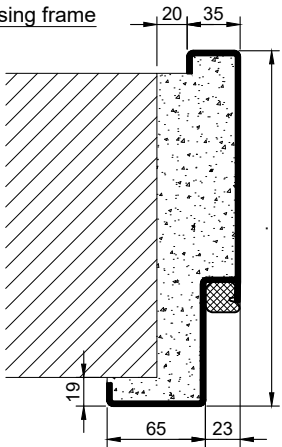
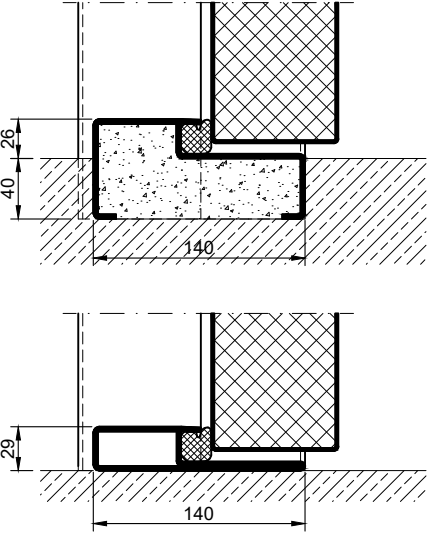
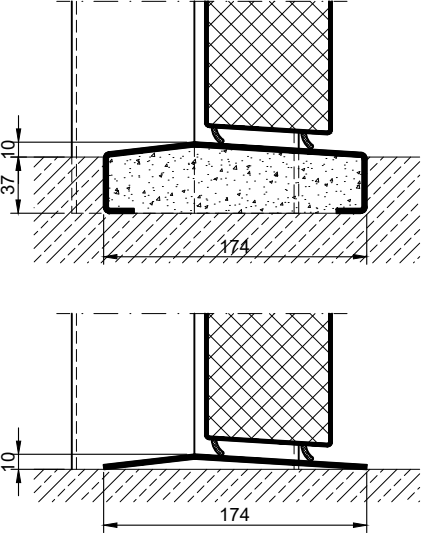
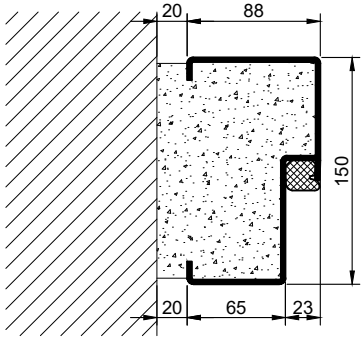
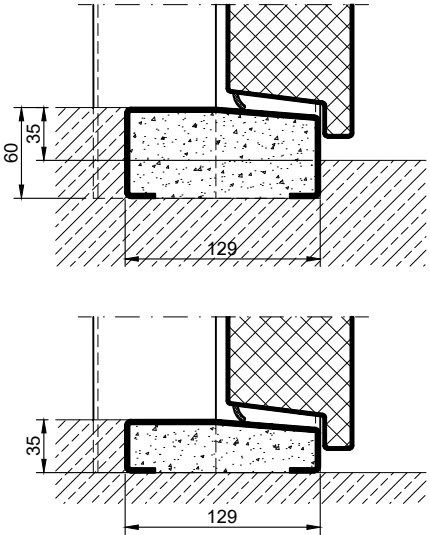
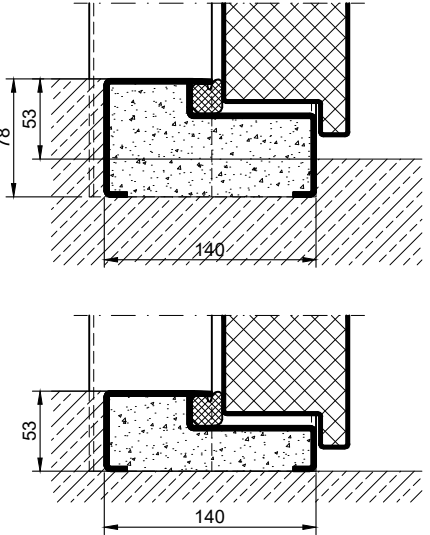
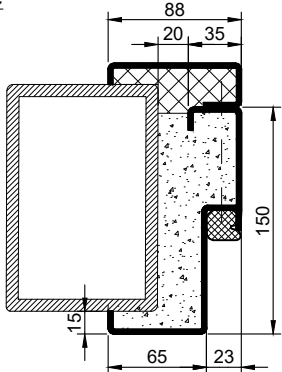
Frames	Thresholds	
<p>corner frame</p> 	<p>drop seal</p> 	
<p>encasing frame</p> 	<p>stop sill with seal</p>  <p>hump sill</p> 	
<p>block frame</p> 	<p>half sill</p>  <p>full sill</p> 	
<p>corner frame with counter frame</p> 		

1.31.13\_PLANE LINE PL 602 XXL 38 DB\_EN

technical modifications reserved - edition 05/2024